

MUFFEN FÜR DIE STAHLROHRE

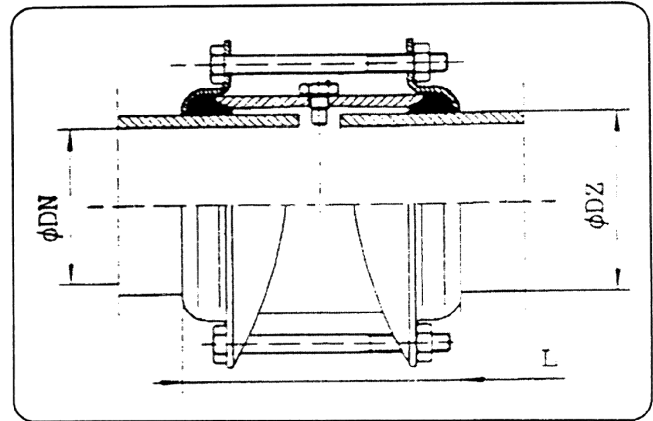

DN	DZ	D	L	Masa
mm	mm	mm	mm	kg

10	13,5	67	60	0,27
15	20	73	60	0,30
20	25	80	66	0,32
25	30	87	66	0,48
32	38	96	66	0,55

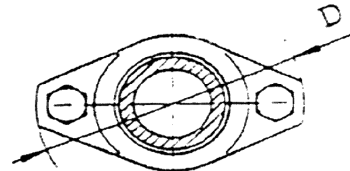

40	44,5	110	110	1,30
40	48,3	110	110	1,30
50	57	123	110	2,00
50	60,3	123	110	2,00
65	76,1	151	120	2,60
80	88,9	164	120	3,10

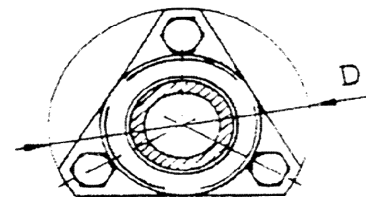

100	108	204	143	5,3
100	114	204	143	5,3
125	133	227	143	6,0
125	139,7	227	143	6,0
150	159	225	143	6,7
160	168	240	143	7,5
200	219,1	315	143	10,5

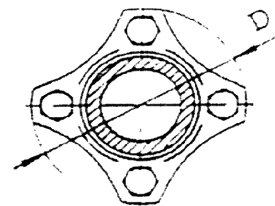

250	273	393	195	16,3
300	323,9	445	195	20,0
350	355,6	478	225	24,0
400	406,4	529	225	30

